

CCH0075LCACZA0000 - SUBMITTAL



Project Name:	-	Project Location:	-
Quote ID:	-	Item #:	8000
Submitted For:	-	Submitted On:	-
Submitted By:	-	Submitted From:	-
Identity #:	-	Tag:	-

☐ For Record

☐ For Approval

By: _____

Date: _____

General Product Information

Product Family:	HCU	Compressor Brand:	Copeland
Application:	Outdoor	Compressor Type:	Scroll
Temperature Range:	Low Temp	Compressor Hp:	7.5
Voltage: (Volts/Ph/Hz)	208-230/3/60	Compressor Model:	ZF25K4E
Refrigerant Type:	R448A	Number of Compressor(s):	1
Piping:	Standard	Coil Type:	Standard Round Tube

Technical Information

Performance Data

Ambient Temperature (°F)	Saturated Suction Temperature (°F)	Application Capacity* (BTU/H)	Altitude (ft)	AWEF Value
95	-10	31,350	0	3.15

Electrical Data

Compressor(s)		Fan Motor(s)			Electric Ratings						
RLA	LRA	Quantity	Hp	FLA	Defrost Type	High or Low Amps?	Number of Contactors	MCA	MOPD	Evap. Fan Amps	Defrost Heater Amps
24	224	1	1/3	2.7	AIR DEFROST	-	-	32.7	50	-	-

Unit Specifications

Connections (in.)		Receiver 90% Full (lbs)		Fan Blade(s) Diameter (in)	Sound Data (dB)	Approx. Net Weight (lbs)
Liquid Line	Suction	Standard	Over Sized			
0.5	1.125	28	52	22	82	671

Dimensional Drawing(s)

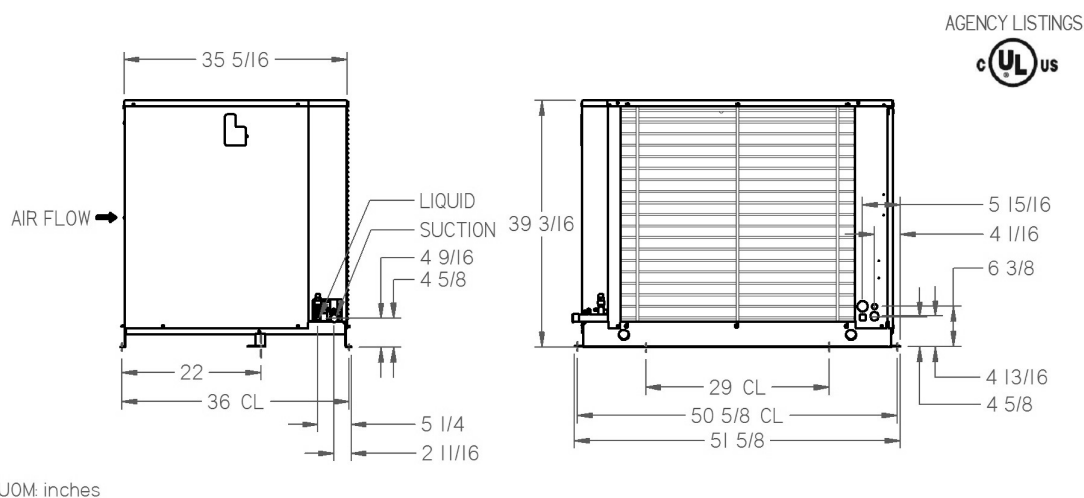

CCH0075LCACZA0000 - SUBMITTAL



Project Name:	-	Project Location:	-
Quote ID:	-	Item #:	8000
Submitted For:	-	Submitted On:	-
Submitted By:	-	Submitted From:	-
Identity #:	-	Tag:	-

Standard Features

QUALITY AND PERFORMANCE

- ALL JOINTS ARE SWEAT TYPE CONNECTIONS, NO MECHANICAL JOINTS TO LEAK
- FIXED HIGH PRESSURE SWITCH ELIMINATES CAPILLARY TUBES
- PIPING IS LAID OUT TO MINIMIZE STRESS AND VIBRATION AND IS PRE-BENT TO ELIMINATE BRAZE JOINTS WHERE POSSIBLE TO REDUCE LEAK POTENTIAL
- PRESSURE RELIEF VALVE ON RECEIVER
- REFRIGERATION DUTY, RIFLED COPPER CONDENSER TUBING
- SEPARATE SUBCOOLING CIRCUIT IN CONDENSER FOR ADDED CAPACITY AND VAPOR FREE LIQUID
- SERVICEMATE™ DIAGNOSTIC MODULE STANDARD ON ALL NON-BEACON™ CONDENSING UNITS
- SIGHT GLASS IS EASILY VIEWABLE

SERVICEABILITY

- CONVENIENT ACCESS PANELS TO EASILY SERVICE INTERNAL COMPONENTS
- LARGE ELECTRICAL PANEL TO FACILITATE EASE OF ACCESS
- MANUAL PUMPDOWN SWITCH ON ALL UNITS

COMPONENTS

- RECEIVERS ARE SIZED FOR SUFFICIENT PUMPDOWN CAPACITY WITH INLET AND OUTLET SERVICE VALVES
- SIGHT GLASS AND PERMANENT LINE FILTER

CABINET AND CONSTRUCTION

- ALL UNITS FEATURE THE FLOATING TUBE™ COIL DESIGN WHICH ELIMINATES TUBE SHEET LEAKS
- PAINTED STEEL CABINET FOR SUPERIOR STRENGTH AND CORROSION RESISTANCE

Options

Mounted Options

- BRAND LABEL OPTION - CLIMATE CONTROL
- Coil Selection - ALUMINUM FIN - COPPER TUBE
- Crankcase Heater - CRANKCASE HEATER
- Defrost Timer Options - NO TIMER
- FAN CYCLING OPTIONS - NO FAN CYCLING
- Phase Loss Monitor - NONE
- Receiver Options - STANDARD
- LIQUID INJECTION COOLING - SCROLL LIQ. INJECTION-R404A
- Fused Disconnect - NO FUSED DISCONNECT
- Compressor Unloading Option - NO COMP UNLOADING
- Cabinet Selection - Painted
- COMPLIANCE - DOE COMPLIANT
- Electric Box Options - STANDARD EBOX
- Discharge Line Options - HEAD PRESSURE VALVE 100#
- Liquid Line Options - FILTER DRIER AND SIGHT GLASS
- Pressure Options - ADJUSTABLE LOW - FIXED HIGH
- Suction Line Options - SUCTION TUBE ONLY
- DEMAND COOLING OPTIONS - NO
- Motor - FIXED SPEED EC

Minimum Unit Clearances

Walls or Obstructions for Horizontal Air Flow

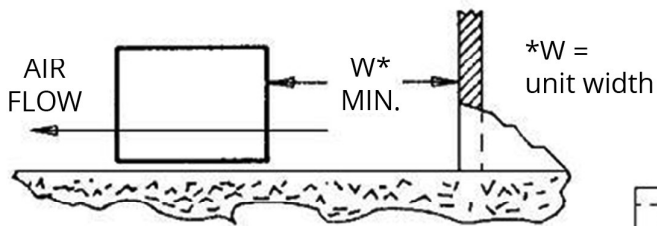

Multiple Units with Horizontal Air Flow

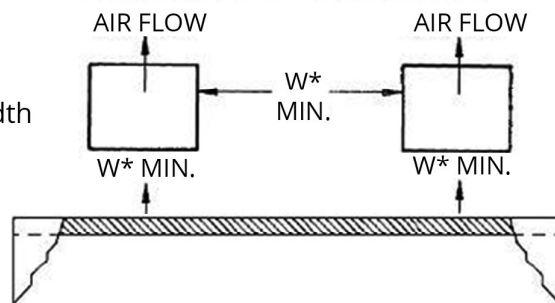

Notes

* Capacities shown are Application Capacities reflecting nominal operation at 10°F TD. For models within the scope of the DOE AWEF (Annual Walk-in Energy Factor) standard, the Net Capacity is determined by the AHRI 1250 test method. DOE will publish this compliance data at www.regulations.doe.gov

*Only refrigerants in compliance with New York state regulations can be used in the state of New York.